

**NAME OF LAND OWNER:-**

**ORCHID INFRA**

OFFICE AT 1ST FLOOR, MTERO HEIGHTS,  
2ND MILE, SEVOKE ROAD, SILIGURI 734001  
P.O. SEVOKE ROAD, P.S. BHAKTINAGAR,  
DIST. JALPAIGURI

REPRESENTED BY ONE OF ITS PARTNER  
SRI DIPAK MUNDHRA  
S/O. SRI BIJAY KUMAR MUNDHRA  
RESIDENT OF PLOT NO. 9, 3RD FLOOR,  
PANCHWATI HOUSING COMPLEX,  
P.O. SEVOKE ROAD, P.S. BHAKTINAGAR,  
DIST. JALPAIGURI

**LAND SCHEDULE:-**

MOUZA : SILIGURI  
J.L. NO. : 93  
SHEET NO. : 20 (R.S.), 02 (L.R.)  
KHATIAN NO. : 2570 (R.S.), 7024 (L.R.)  
PLOT NO. : 11828/13070 (R.S.), 619 (L.R.)  
P.S. : SILIGURI  
DIST. : DARJEELING  
WARD NO. : 30 (S.M.C)

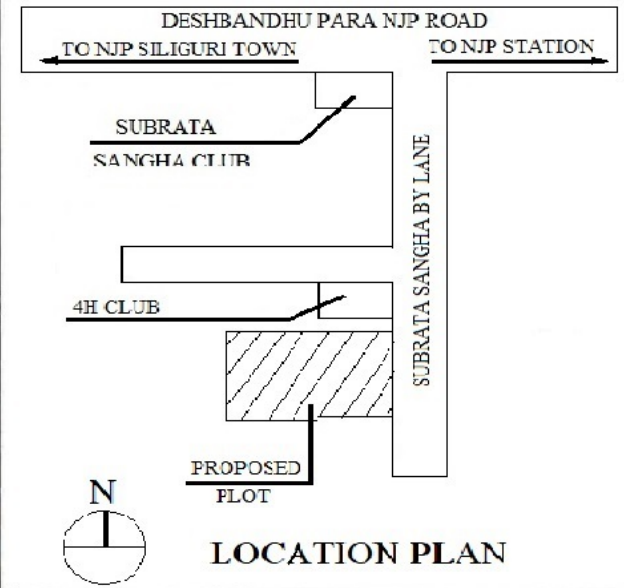
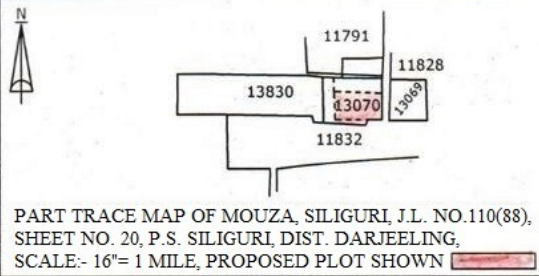

**LAND AREA : 7 KATHA 12 CHATTAK OR 518.39 SQ. M.**

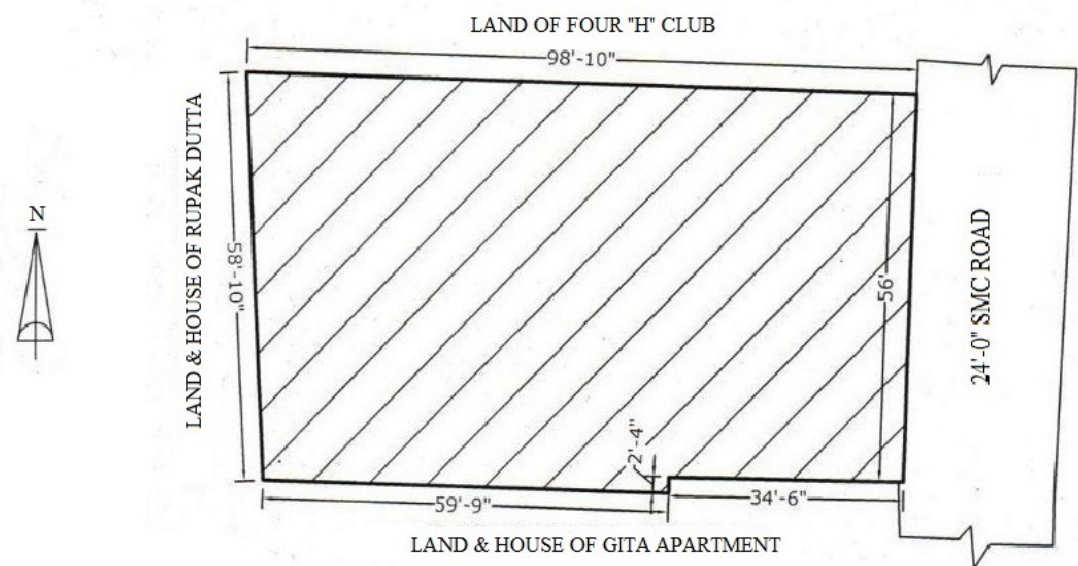

Latitude : 26° 41' 44.592" N  
Longitude : 88° 25' 56.028" E

**ORCHID INFRA**  
*Dipak Mundhra*  
Partner

Signature of Land Owner

SITE PLAN  
SCALE:- 1" = 30'0"  
PROPOSED PLOT SHOWN